

Where to use barrier matting

An effective barrier matting system, when correctly specified, will help to minimise the risk of slip accidents caused by wet flooring and lower maintenance costs by significantly reducing the amount of dirt and moisture tracked into a building. Barrier matting can not only be used at a building's entrance and access points but also in other areas that are subject to increased risk of soiling and heavy wear. In many cases the optimum performance is achieved by combining different types of barrier matting.

The illustration below is designed to act as a guide to show some of the areas of a building that are at risk. These are divided into zones, which are referred to throughout the catalogue.

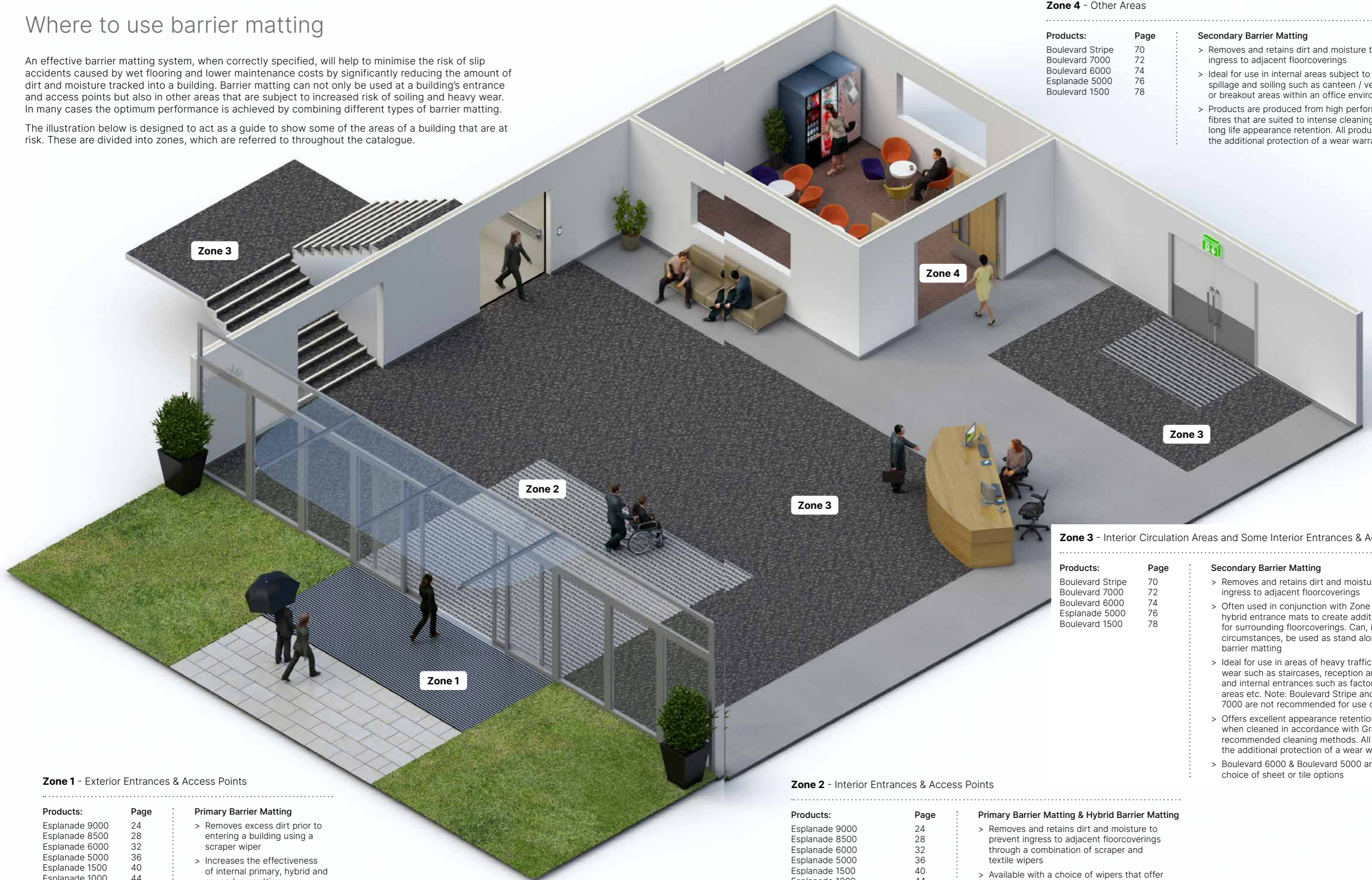

Zone 1 - Exterior Entrances & Access Points

Products:	Page	Primary Barrier Matting
Esplanade 9000	24	<ul style="list-style-type: none"> > Removes excess dirt prior to entering a building using a scraper wiper > Increases the effectiveness of internal primary, hybrid and secondary matting > Ideal in heavy traffic areas
Esplanade 8500	28	
Esplanade 6000	32	
Esplanade 5000	36	
Esplanade 1500	40	
Esplanade 1000	44	
Tyreguard	52	

Zone 2 - Interior Entrances & Access Points

Products:	Page	Primary Barrier Matting & Hybrid Barrier Matting
Esplanade 9000	24	<ul style="list-style-type: none"> > Removes and retains dirt and moisture to prevent ingress to adjacent floorcoverings through a combination of scraper and textile wipers > Available with a choice of wipers that offer excellent appearance retention when cleaned in accordance with Gradus recommendations > Available in a choice of open and closed construction and in different gauges to suit both recessed and surface mounted options > Available to suit varying types and volumes of traffic
Esplanade 8500	28	
Esplanade 6000	32	
Esplanade 5000	36	
Esplanade 1500	40	
Esplanade 1000	44	
Topguard	48	
Tyreguard	52	
Mat-in-a-Box 6000 & 5000	58	
Mat-in-a-Box 1550	61	
Access 6000 & 5000	64	

Zone 4 - Other Areas

Products:	Page	Secondary Barrier Matting
Boulevard Stripe	70	<ul style="list-style-type: none"> > Removes and retains dirt and moisture to prevent ingress to adjacent floorcoverings > Ideal for use in internal areas subject to a risk of spillage and soiling such as canteen / vending areas or breakout areas within an office environment > Products are produced from high performance fibres that are suited to intense cleaning to ensure long life appearance retention. All products carry the additional protection of a wear warranty
Boulevard 7000	72	
Boulevard 6000	74	
Esplanade 5000	76	
Boulevard 1500	78	

Zone 3 - Interior Circulation Areas and Some Interior Entrances & Access Points

Products:	Page	Secondary Barrier Matting
Boulevard Stripe	70	<ul style="list-style-type: none"> > Removes and retains dirt and moisture to prevent ingress to adjacent floorcoverings > Often used in conjunction with Zone 2 primary and hybrid entrance mats to create additional protection for surrounding floorcoverings. Can, in some circumstances, be used as stand alone entrance barrier matting > Ideal for use in areas of heavy traffic and heavy wear such as staircases, reception areas, lift lobbies and internal entrances such as factory to office areas etc. Note: Boulevard Stripe and Boulevard 7000 are not recommended for use on staircases > Offers excellent appearance retention properties when cleaned in accordance with Gradus recommended cleaning methods. All products carry the additional protection of a wear warranty > Boulevard 6000 & Boulevard 5000 are available in a choice of sheet or tile options
Boulevard 7000	72	
Boulevard 6000	74	
Esplanade 5000	76	
Boulevard 1500	78	